



WESTERN VIRGINIA
REGIONAL INDUSTRIAL FACILITY AUTHORITY

The logo is a white rounded rectangle with a green and orange horizontal bar at the bottom. The text is in a bold, blue, sans-serif font.



WVRIFA AND PC JOINT MEETING
6.19.2020

The background is a wide-angle aerial photograph of a city, likely Roanoke, Virginia, showing a dense urban area with various buildings, roads, and a river. In the distance, there are rolling mountains under a blue sky with scattered white clouds. The foreground shows some dry, brown grasses.

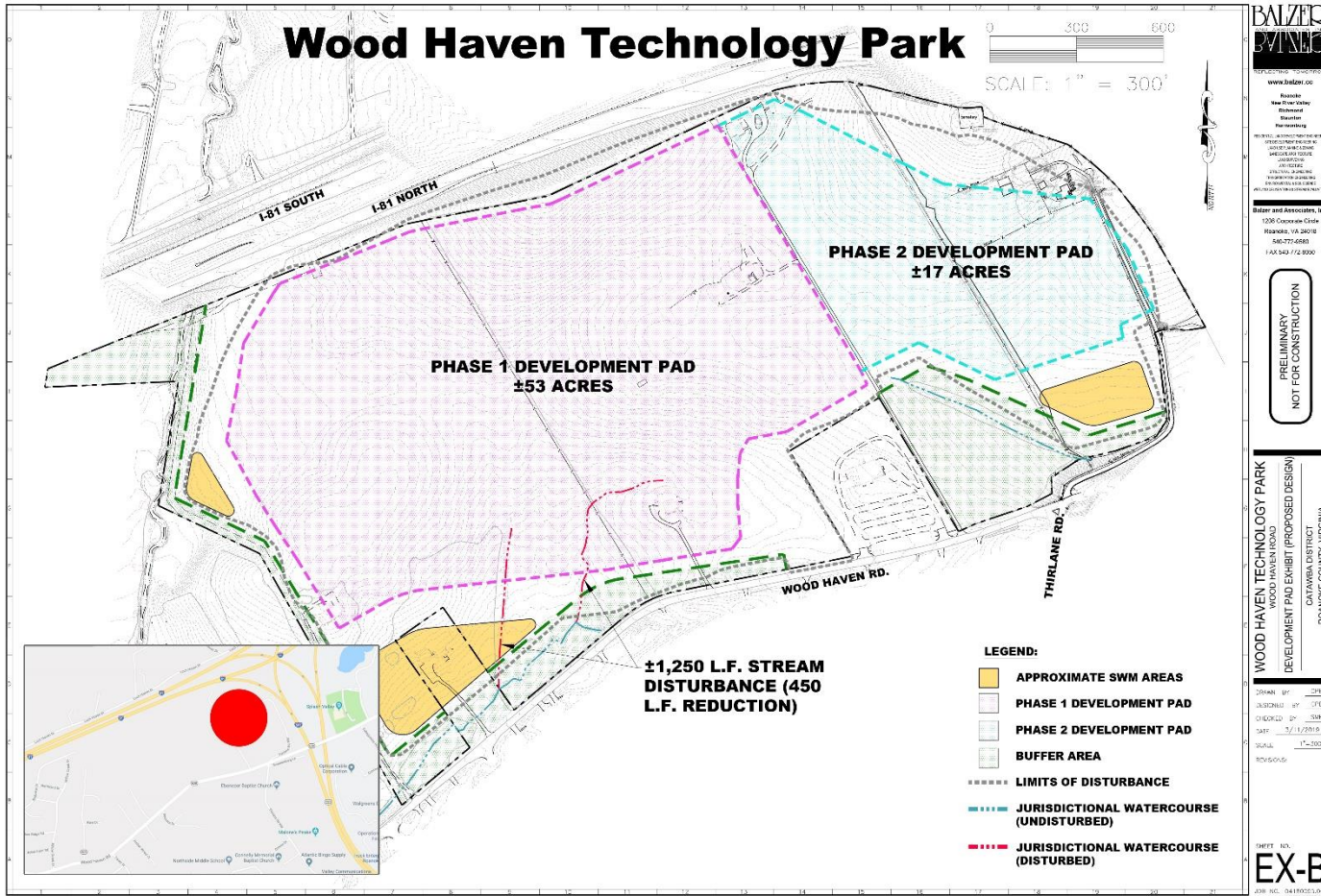

VDOT COORDINATION



Project Updates

Construction – Innovation Drive

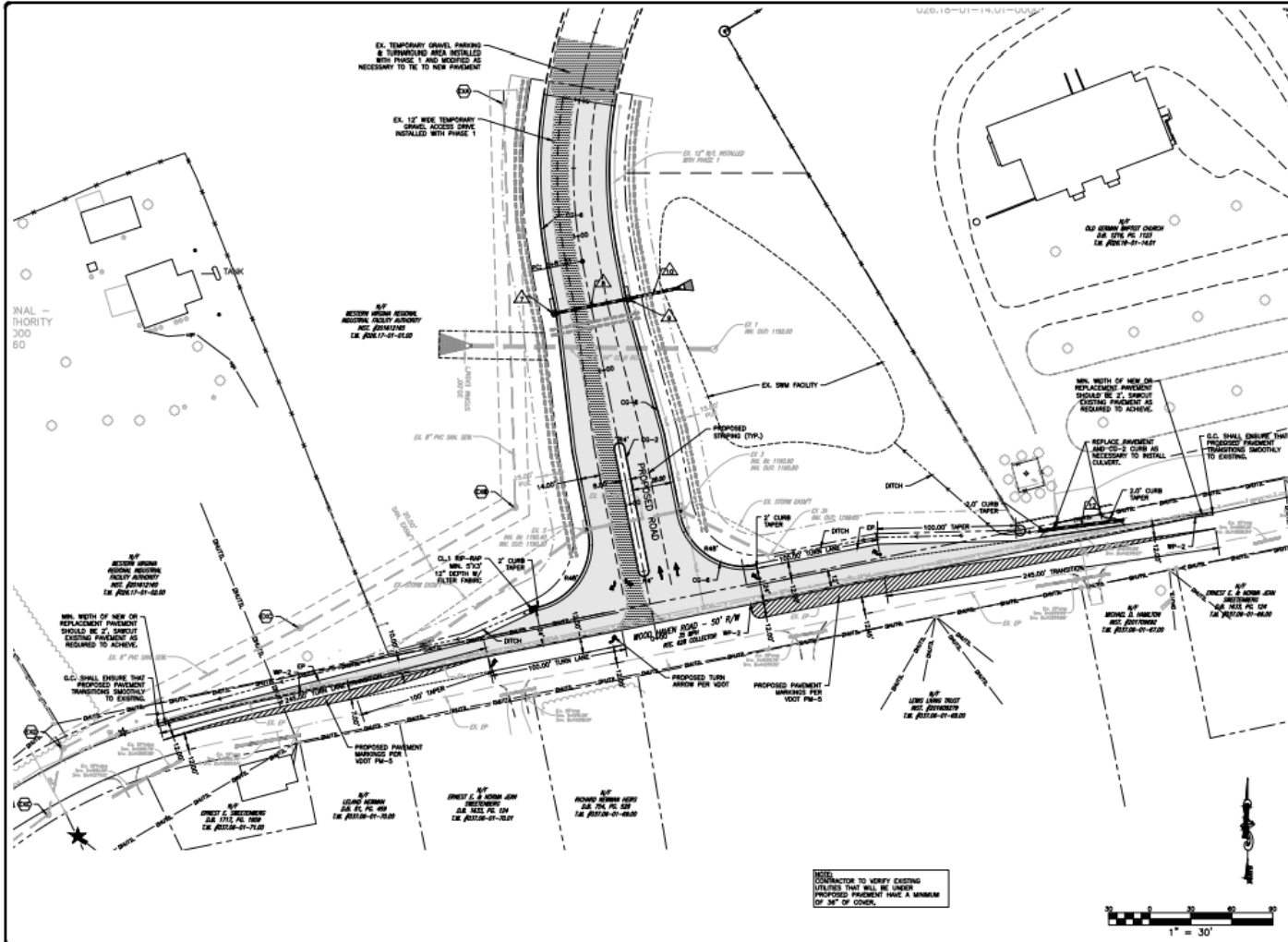

BALZER
PLANNERS • ARCHITECTS
ENGINEERS • ENVIRONMENTALISTS

Richard J. Richard
New Market Office • 2200
Northwest Highway 10 Building
Columbia, SC 29225

www.baizer.com
616 Broadway Street
Suite 411
Columbia, SC 29203

(803) 732-5100

12/17/19

12/17/19

12/17/19

12/17/19

12/17/19

12/17/19

12/17/19

12/17/19

12/17/19

12/17/19

12/17/19

12/17/19

12/17/19

12/17/19

12/17/19

12/17/19

12/17/19

12/17/19

12/17/19

12/17/19

12/17/19

12/17/19

12/17/19

12/17/19

12/17/19

12/17/19

12/17/19

12/17/19

12/17/19

12/17/19

12/17/19

12/17/19

12/17/19

12/17/19

12/17/19

12/17/19

12/17/19

12/17/19

12/17/19

12/17/19

12/17/19

12/17/19

12/17/19

12/17/19

12/17/19

12/17/19

12/17/19

12/17/19

12/17/19

12/17/19

12/17/19

12/17/19

12/17/19

WOOD HAVEN TECHNOLOGY PARK ROAD IMPROVEMENTS
LAYOUT AND UTILITY PLAN

DRAWN BY: JMR
CHECKED BY: JMR
DATE: 12/17/19
SCALE: AS SHOWN
PROJECT NO: 19-022
SHEET NO: C3

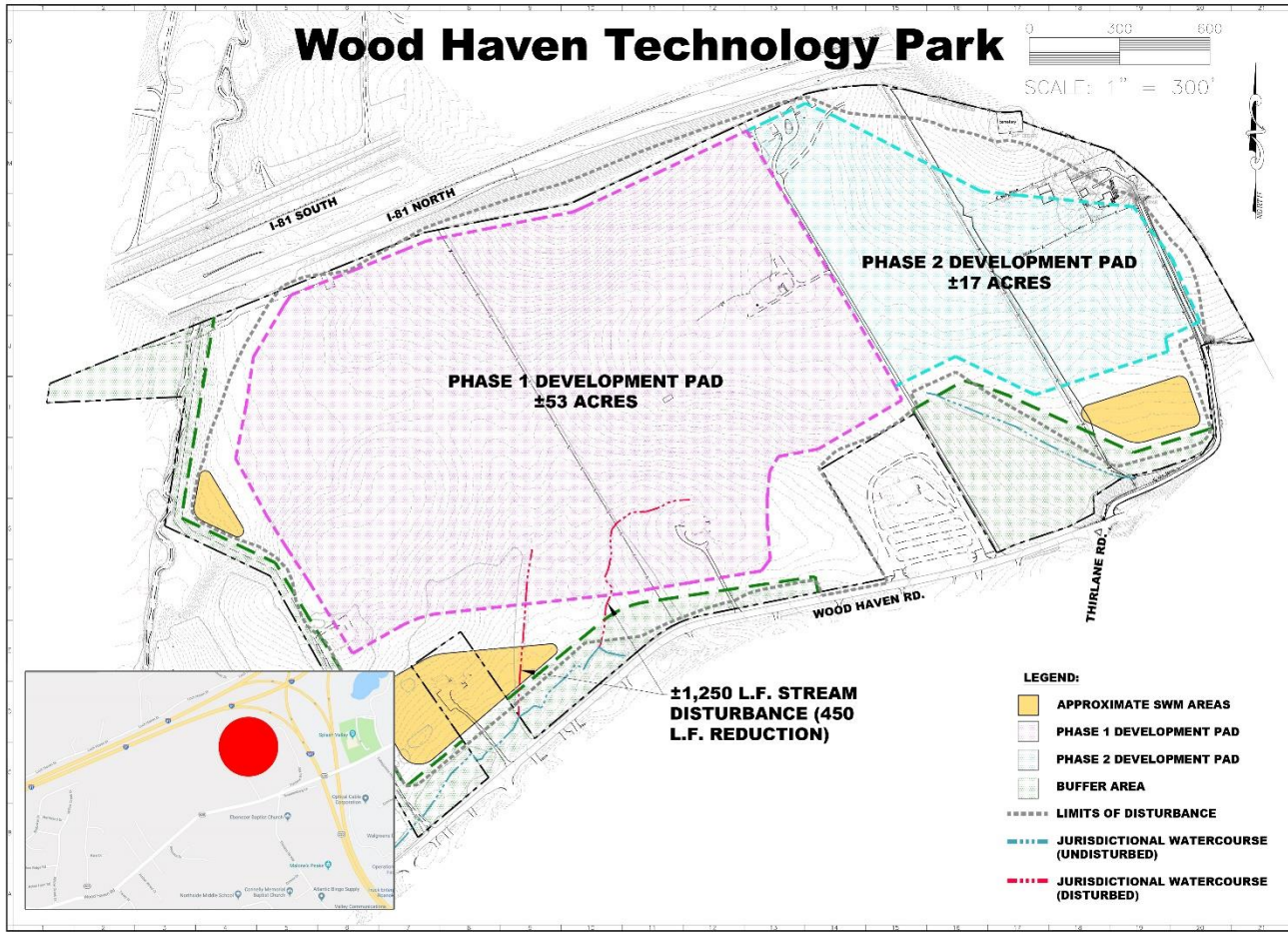

BALZER ENGINEERING

www.balzer.com

Roanoke
New River Valley
Blacksburg
Martinsburg

PROJECT: WOOD HAVEN TECHNOLOGY PARK
 DEVELOPMENT PAD EXHIBIT (PROPOSED DESIGN)
 PRELIMINARY DESIGN
 DATE: 5/11/2016
 SCALE: 1"=300'

Balzer and Associates, Inc.
 1200 Commerce Circle
 Roanoke, VA 24018
 540.771.6880
 FAX 540.772.8000

WOOD HAVEN TECHNOLOGY PARK
 WOOD HAVEN ROAD
 DEVELOPMENT PAD EXHIBIT (PROPOSED DESIGN)
 CATARAUGA DISTRICT
 ROANOKE COUNTY, VIRGINIA

DRAWN BY: JML
 CHECKED BY: JFO
 DATE: 5/11/2016
 SCALE: 1"=300'

SHEET NO. **EX-B**
 JOB NO. 0418005230

GRADING/CLEARING

An aerial photograph of a city in Western Virginia, showing a mix of residential and commercial buildings, a major highway interchange, and a river winding through the landscape. The city is set against a backdrop of rolling mountains under a blue sky with scattered white clouds. In the foreground, some bare, brown branches are visible. A white rounded rectangular box with a green and orange horizontal bar is overlaid on the top left of the image, containing the text 'WESTERN VIRGINIA REGIONAL INDUSTRIAL FACILITY AUTHORITY'.

WESTERN VIRGINIA
REGIONAL INDUSTRIAL FACILITY AUTHORITY